

# SAINT PAUL'S UNITED METHODIST CHURCH

- 322 Choir Room
- 332D Senior Pastor Office
- 325 4-5 Year Old / Hand Bells
- 326 2-3 Year Old
- 327 Nursery B
- 328 Nursery A
- 332E Assoc. Pastor's Office
- 332A Church Office

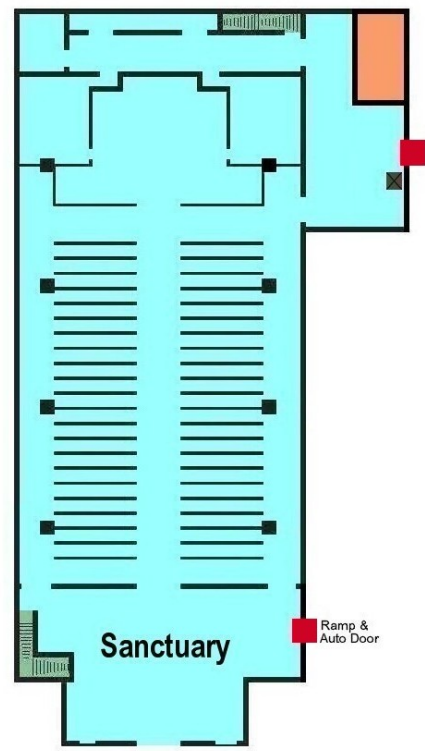
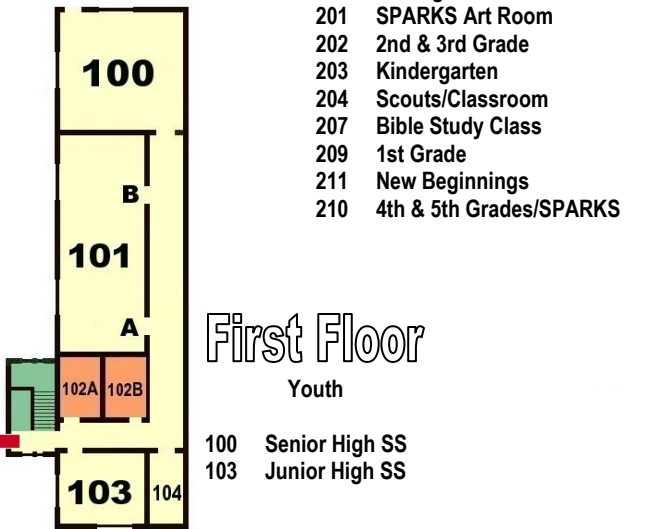
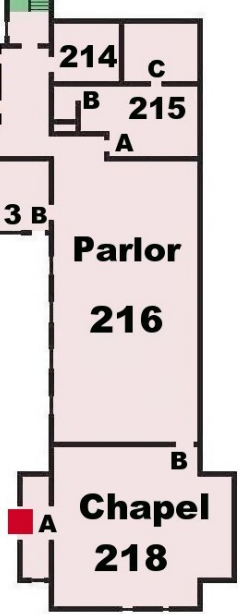
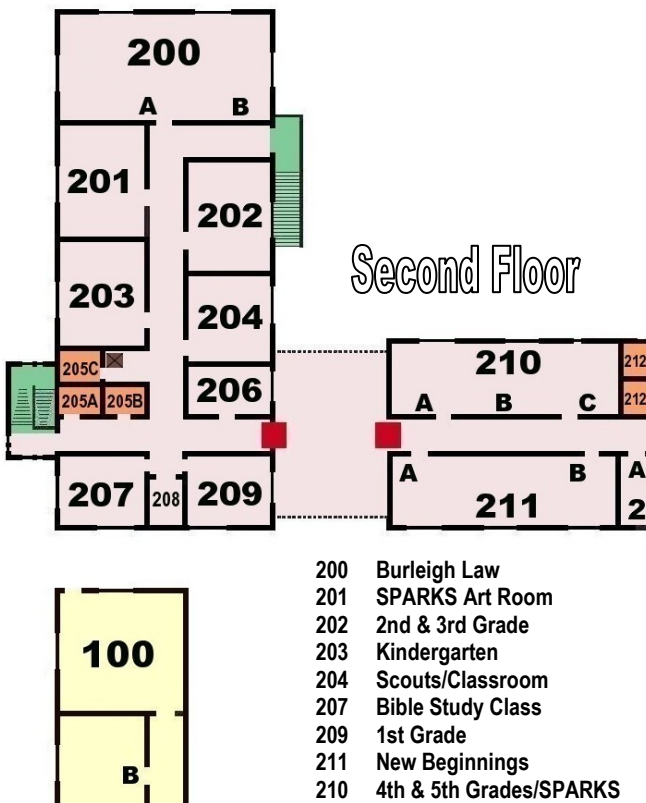
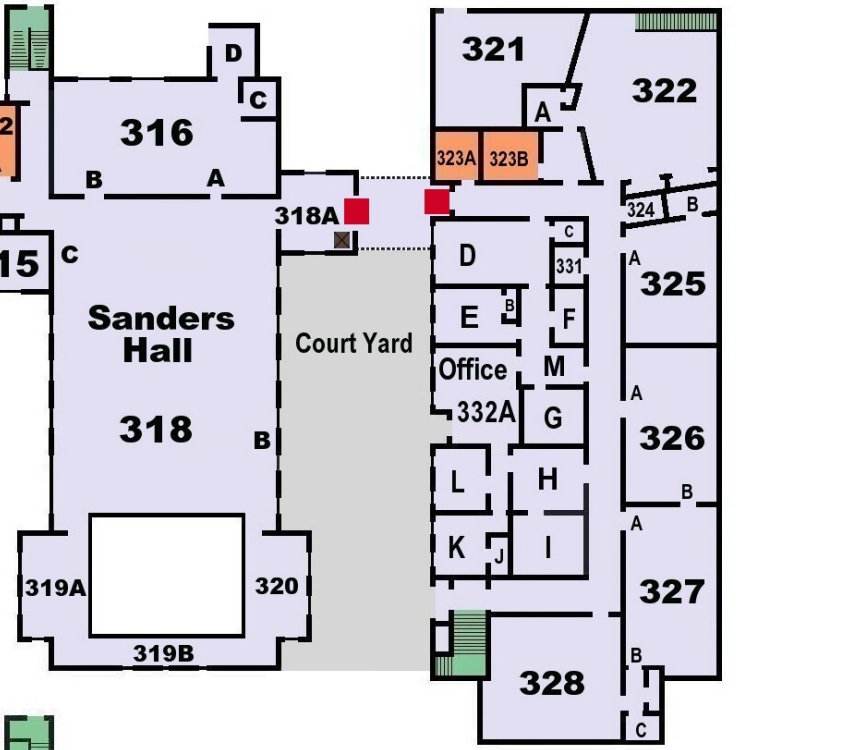
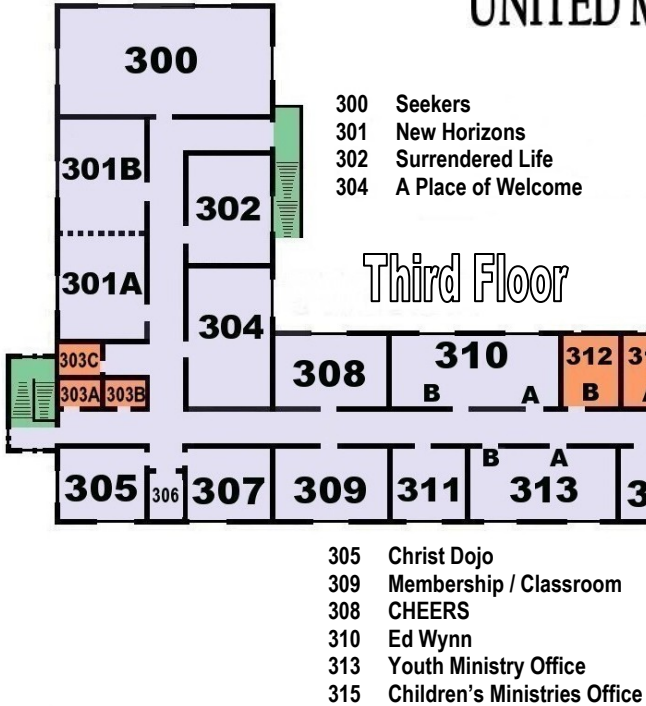

- Handicap Access
- Rest Rooms
- Automated External Defibrillator

**Foundation**

North